

FY 2018-19 ANNUAL ENGINEER'S REPORT HEALDSBURG LANDSCAPING & LIGHTING ASSESSMENT DISTRICT

City Council

June 18, 2018



Landscaping & Lighting Assessment District Staff Recommendation

- Hold a public hearing and receive public comments or protests on the Annual Engineer's Report, the proposed budget for the Healdsburg Landscaping and Lighting Assessment District and annual Assessments
- Adopt a Resolution approving the Annual Engineer's Report, confirming the assessment diagram and annual assessment amounts and authorizing the levying and collection of assessments for FY 2018-19 for the Assessment District



Landscape & Lighting Assessment District Background

- Original Assessment District formed in 1996
- 2018-19 Landscaping and Lighting (LLAD) District covers 6 existing Zones
- Funds collected from the LLAD help maintain street landscaping areas, Barbieri Park, Sorrento pocket park, and utility costs associated with landscaping
- Per the Streets and Highways Code, annual Engineer's Reports are required (3-step process)
- Tonight's Public Hearing is the final step for this year

Landscaping & Lighting Assessment District Map

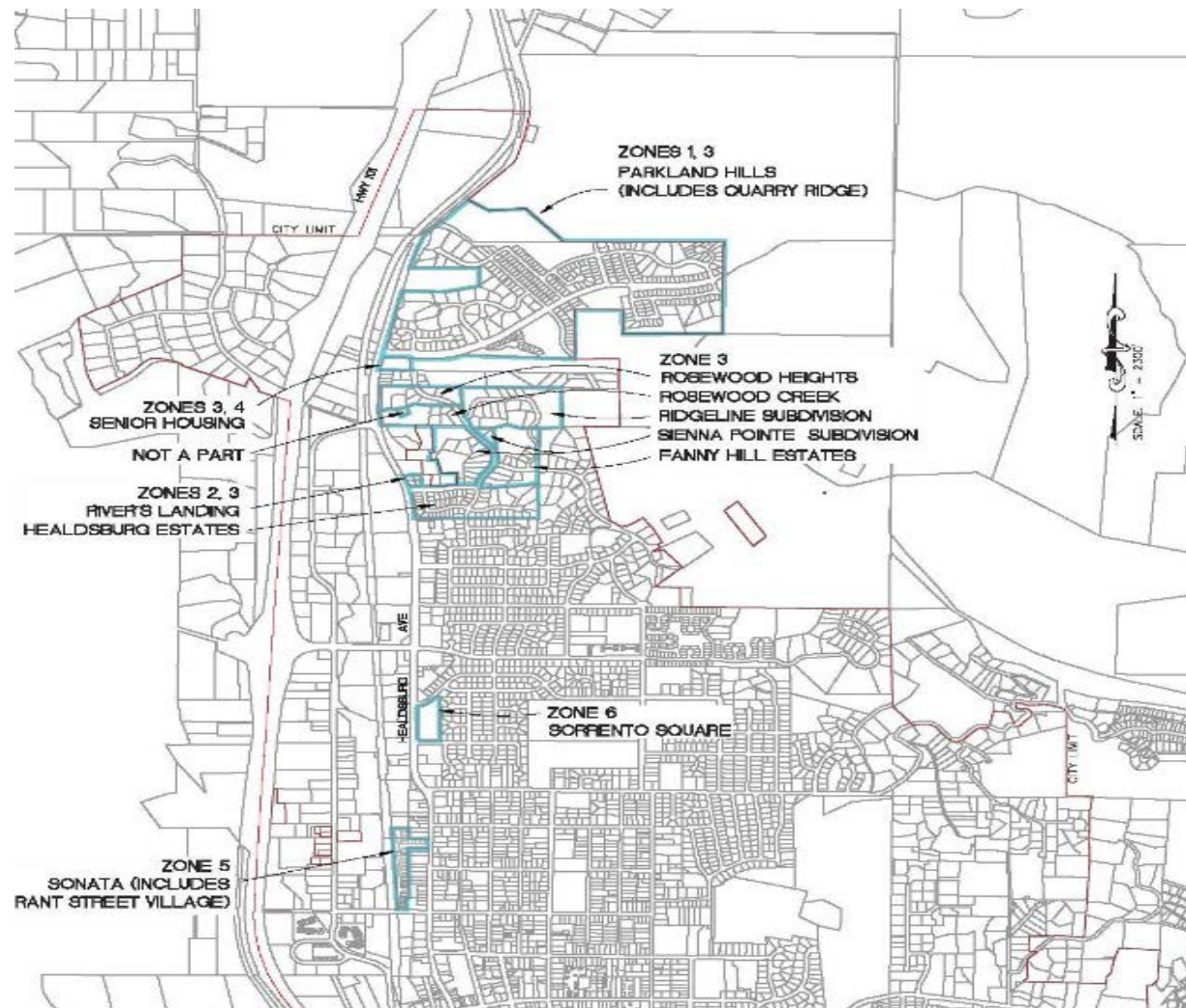

Landscaping & Lighting Assessment District Changes for FY2018-19

- Assessments for Zones 1-5 proposed to stay the same as FY2018-19
- Zone 6 is proposed to decrease as actual costs have been identified and the completion of all homes in the subdivision has reduced amount for each dwelling unit
- Reserves in most zones are above the City's stated reserve policy

Landscaping & Lighting Assessment District

Proposed Assessment for FY 2018-19

	FY 2017-18 Assessments per ESD	FY 2018-19 Proposed Assessments per ESD
Zone 1	\$211.40	\$211.40
Zone 2	\$111.90	\$111.90
Zone 3	\$144.96	\$114.96
Zone 4	\$197.38	\$197.38
Zone 5	\$473.00	\$473.00
Zone 6	\$758.68	\$664.22

Landscaping & Lighting Assessment District

Recommended Action

- Hold a public hearing and receive public comments or protests on the Annual Engineer's Report, the proposed budget for the Healdsburg Landscaping and Lighting Assessment District and annual Assessments
- Adopt a Resolution approving the Annual Engineer's Report, confirming the assessment diagram and annual assessment amounts and authorizing the levying and collection of assessments for FY 2018-19 for the Assessment District
- Questions?